



## DOOR REPLACEMENT

### Front Door (All Models)

#### Removal

On vehicles with electric windows, disconnect the wires from window regulator motor and remove from door assembly.

(1) With door in wide open position, place a jack, with a block of wood or pad on lifting plate of jack, as

near hinge as possible. (This will hold weight of door as hinge bolts are loosened.)

(2) Remove door interior trim and hardware.

(3) Scribe a line around upper and lower hinge plates on door panel.

(4) Remove hinge attaching screws from door and remove door for further disassembly if necessary.

#### Installation

(1) With door inner hardware installed, place door in position in door opening, supported by a padded jack.

On electric window lifts, install wiring in doors and attach to motor and control switch.

(2) Locate door hinge plates on door panel and install hinge attaching screws finger tight only.

(3) Adjust jack to align hinge plate scribe marks and tighten attaching screws.

(4) Complete door aligning procedure, and install door interior trim and hardware.

### REAR DOOR (All Models)

#### Removal

On vehicles with electric window lifts disconnect wires from motor and control switch and remove from door prior to door removal.

(1) Open rear door and place a padded jack under door near the hinges.

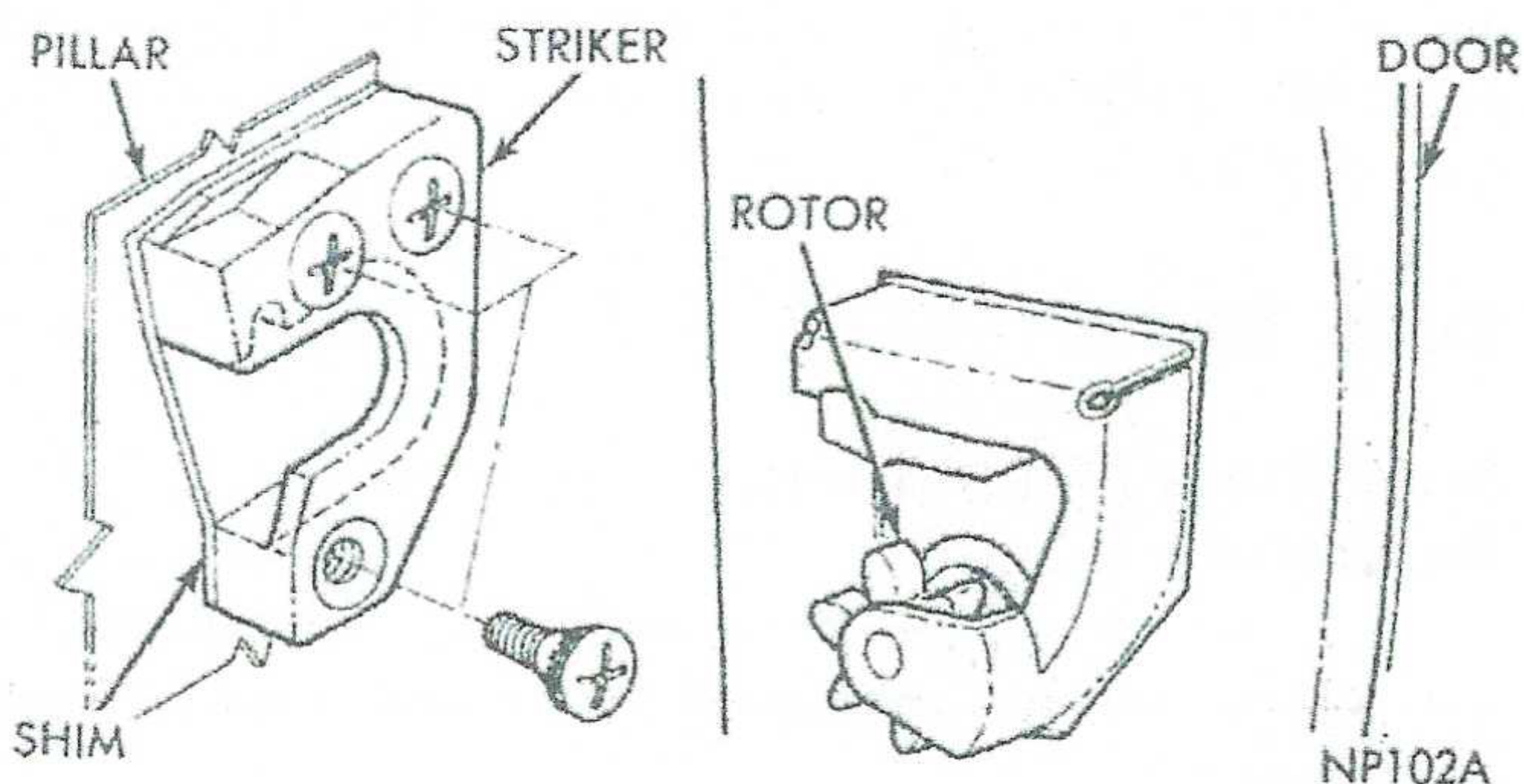

Fig. 17—Striker and Rotor

(2) Remove door interior trim and hardware.

(3) Scribe aligning marks around hinge plates on door frame.

(4) Remove hinge attaching screws from door and remove door from body.

#### Installation

(1) With rear door inner hardware installed, support door on a padded jack and position door on hinges.

(2) Install attaching bolts finger tight.

(3) Align hinges with scribe marks.

(4) Tighten attaching screws and test door for alignment.

(5) Install door interior trim and hardware.

On vehicles with electric window lift, insert wiring into the door and attach wiring to motor and control switch prior to installation of trim panel.

## HINGE REPLACEMENT

The door hinges (Fig. 16) are attached to the doors by screws accessible from outside. The front door hinges are each attached to the "A" post by three screws.

The rear door upper hinges (on hardtop and station wagon models), are attached to the "B" post by three screws accessible from outside. On sedan models, the screws are accessible through an access hole in the "B" post.

## INSIDE HANDLES

### Window Regulator Handle

The window regulator handles are retained on the shaft with an allen set screw. The handles should be positioned on the shaft approximately in a horizontal position with the knobs facing rearward.

### Remote Control Handle

The remote control handle (Fig. 18) is attached to the control unit with a screw at the rear inner end.

## ARM RESTS

The arm rests are retained by two metal screws

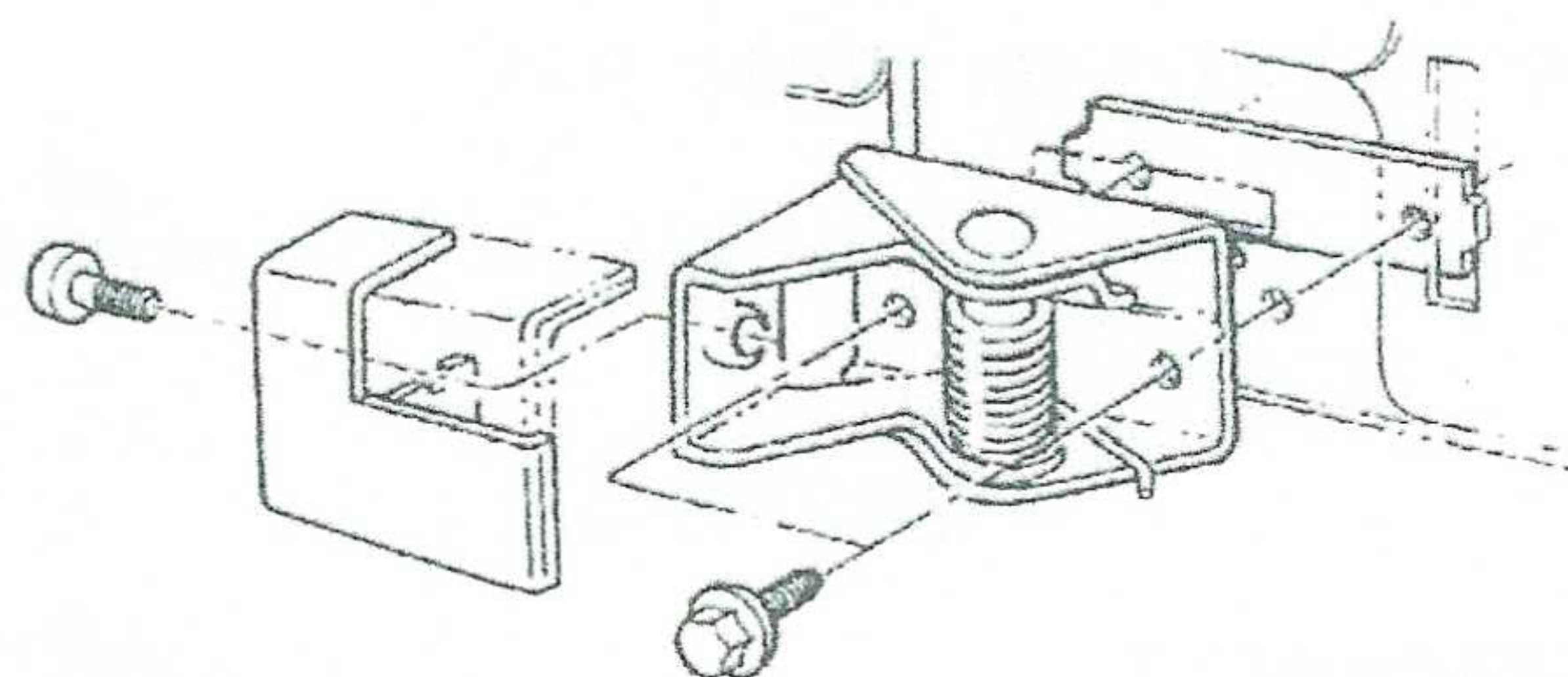

NN605

Fig. 18—Remote Control Handle